

Parts List - TG123V

TG123V 3.8m TIG Torch
TG123V 7.6m TIG Torch

1411615
1411620

125 Amps @ 60% Duty Cycle DC-ve
75 Amps @ 60% Duty Cycle AC

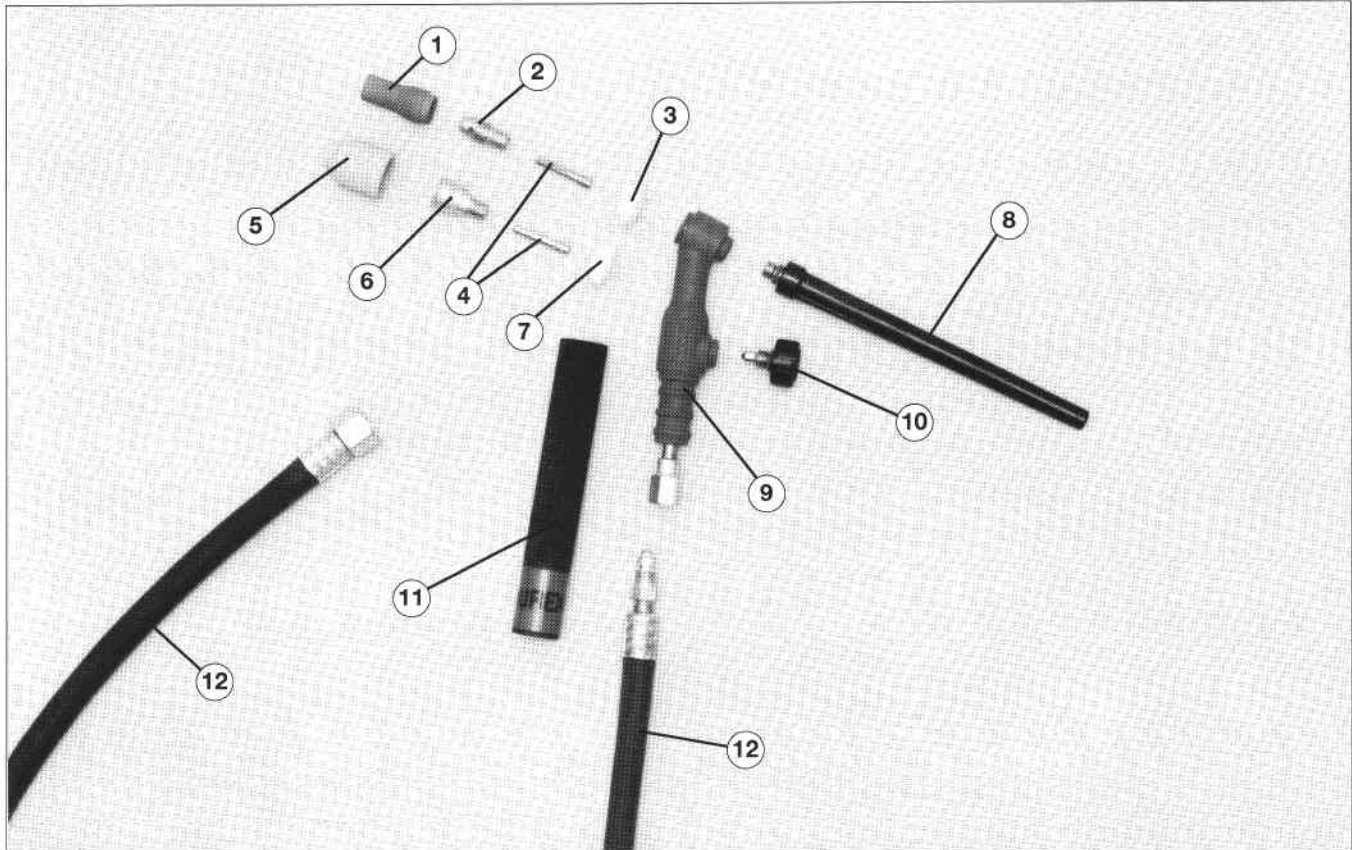

Nozzles / Collet Bodies		
▲ 1	Ceramic Nozzle 47mm x 6mm Pk10	1408340
● 1	Ceramic Nozzle 47mm x 8mm Pk10	1408341
▲ 1	Ceramic Nozzle 47mm x 10mm Pk10	1408342
▲ 1	Ceramic Nozzle 47mm x 11mm Pk10	1408343
1	Ceramic Nozzle 47mm x 13mm Pk10	1408344
* 2	Collet Body 0.5mm	1408080
*▲2	Collet Body 1.0mm	1408081
*●2	Collet Body 1.6mm	1408082
*▲2	Collet Body 2.4mm	1408083
3	Nozzle Gasket	1411633

Collets		
4	Collet 0.5mm Pk5	1410880
4	Collet 1.0mm Pk5	1410881
4	Collet 1.6mm Pk5	1410882
4	Collet 2.4mm Pk5	1410883

Switches and Components		
NS	Momentary Switch (SW1F)	1411668
NS	On/Off Switch (SW2)	1411669
NS	Strap-On Switch (SW3)	1411735
NS	Switch Kit 3.8m (SW3)	1412221
NS	Switch Kit 7.6m (SW3)	1412222
NS	Switch Boot 19mm dia. (SW1F)	1411670
NS	Switch Boot 19mm dia. (SW2)	1411671

Nozzles / Gas Lenses		
5	Gas Lens Nozzle 41mm x 6mm Pk5	1408360
5	Gas Lens Nozzle 41mm x 8mm Pk5	1408361
5	Gas Lens Nozzle 41mm x 10mm Pk5	1408362
5	Gas Lens Nozzle 41mm x 11mm Pk5	1408363
* 6	Gas Lens Collet body 0.5mm	1408100
* 6	Gas Lens Collet Body 1.0mm	1408101
* 6	Gas Lens Collet Body 1.6mm	1408102
* 6	Gas Lens Collet Body 2.4mm	1408103
7	Gas Lens Insulator	1411633

Components		
▲ NS	Short Back Cap with O Ring	1408140
NS	Medium Back Cap with O Ring	1408141
● 8	Long Back Cap with O Ring	1408142
9	Torch Body	1411625
10	Valve with O Ring	1411626
11	Torch Handle 19mm Diameter	1411627
◆ 12	Power/Gas Lead Assembly 3.8m	1411628
◆ 12	Power/Gas Lead Assembly 7.6m	1411629
NS	Neoprene Rubber 13.7m	1411674
NS	Protective Zip Cover 3.1m	1411672
NS	Protective Zip Cover 6.7m	1411673
NS	Torch Accessory Kit	1408020

Torch Switch Plugs		
NS	Plug 2-pin	1407817
NS	Plug 3 Pin	607574
NS	Plug 4 Pin	627018
NS	Plug 6 Pin	607771

KEY

- * Collet Bodies include one collet of matching size
- ◆ Coaxial power/gas cable fitted with 1/4" BSP nut and bullnose fitting
- ▲ Items contained in accessory kit
- Consumable items supplied with torch
- NS Not Shown

Optional

1/4" BSP - 25mm ² Dinse Gas/Power Adaptor	1407737
--	---------